



Streetlamp Integrated

# Electric Vehicle Charger

**chargegrid**  
**FLARE**



## KEY FEATURES

With its stylish shape, modern lines and patented technology, ChargeGrid FLARE meets the demand of innovative design, urban looks and rugged use.

- OCPP 1.6 communication protocol
- Available connection options:  
**Type-2 socket**  
**IEC 60309 socket**
- Equipped with** Internet communication
- Vandal resistant design, for high risk and susceptible public locations
- Charger's housing has been built to be robust to withstand both mechanical stress and harsh environmental conditions
- Mobile app based, intelligent On/Off system, payment gateway and user authentication to avoid electricity theft

## Suitable for

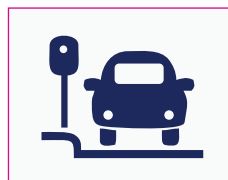

Kerbside Charging

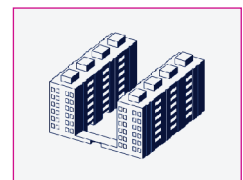

Residential Complex



Malls



Parking Bays

# TECHNICAL SPECIFICATION

INPUT POWER	
Input Voltage (AC)	Single phase, 230 Vac
Input Frequency	50Hz
Wires	L, N an PE(Ground)
OUTPUT POWER	
Number of Outputs	1
Output Connector	IEC60309 / Type 2
Output Current	16A / 32A
Output Rating	3.3kW / 7.2kW
ENVIRONMENT	
Ambient Temperature	-40°C to +80°C
Operating Temperature	-5°C to 55°C
Altitude	<2000Mtr
Humidity	<95%, Non-condensing
PROTECTION	
Protection	Over voltage, under voltage, over current, short circuit, surge protection, over temperature, ground fault, residual current
Compliance & Safety	IEC
USER INTERFACE & CONTROL	
Display	Optional
Language	English
Emergency Stop	N/A
User Authentication	Mobile App
Visual Indication	LED for Idle, Fault & Charging status
COMMUNICATION	
Charger & CMS	OCPP 1.6 (Upgradable to OCPP 2.0)
Network Connection	Sim: 2G/3G/4G , Ethernet, Bluetooth
MECHANICAL	
Ingress Protection	IP55 (Charger module)
Cooling	Natural cooling
Dimensions (Charger module)	650mm (L) x 120mm (W) x 150mm (H)
Dimensions (Pole)	700mm (H) x 165mm (OD)
Weight	80 Kg (Approx.)

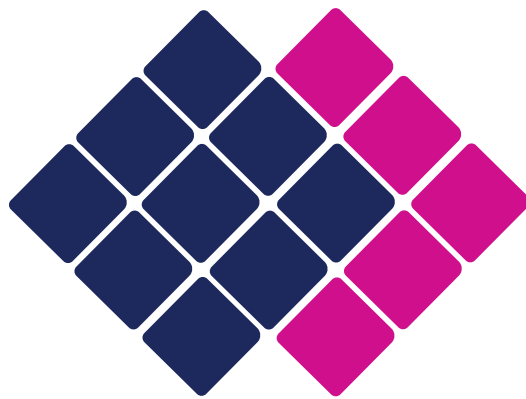

**magenta**

**Magenta EV Solutions Pvt. Ltd.**

✉ [sales@magentagroup.com](mailto:sales@magentagroup.com)

🌐 [www.magentagroup.com](http://www.magentagroup.com)



Toll Free Number

**1800 123 0267**

Navi Mumbai • Bengaluru